

A19.a

Comune di
Martellago

oggetto **PIANO DI LOTTIZZAZIONE " TERESA CASATI "**

contenuto Progetto fabbricato bifamiliare tipo 2
Piante

ditta **DREAM HOUSE S.r.l.**

data 12/2016

aggiornato

cartella 25/2016

scala 1/100

monica cornello architetto

piazza IV novembre 25, 30030 maerne di martellago VE
tel/fax 041 5460822
cf. CRNMNC68R54L736L P.IVA 00928210277
e-mail: cornello.monica@tiscali.it
posta PEC: monica.cornello@archiworldpec.it

claudio bergo geometra





piazza IV novembre 104, 30030 maerne di martellago VE
tel/fax 041 5030295
cf. BRGCLD70L28L736Z P.IVA 02895440275
e-mail: info@studiobergolab.it
posta PEC: claudio.bergo@geopec.it

StB
www.studiobergolab.com

DREAM HOUSE S.r.l.

piazza IV Novembre 104
30030 maerne di martellago VE
cf./p.iva 04366930271 - REA VE.406092

LEGENDA

-  pannelli fotovoltaici
-  caldaia a camera stagna, kcal/h 30'000
-  aerazione permanente con alettatura sul basculante, pari a 1/100 della superficie
-  le distanze dai confini e dai fabbricati limitrofi dell'ampliamento di progetto, sono calcolate sul filo esterno del muro dello spessore di cm 30

PIANTA PIANO TERRA

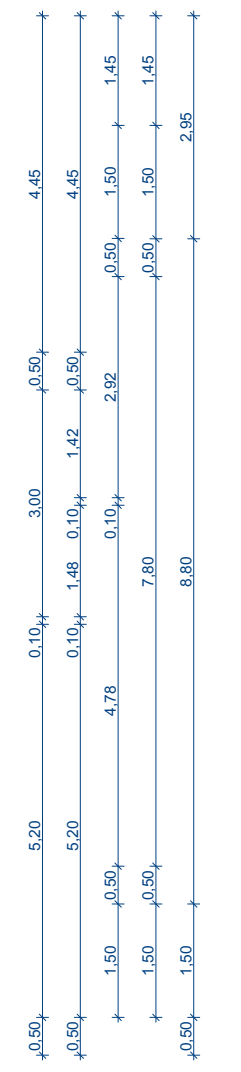
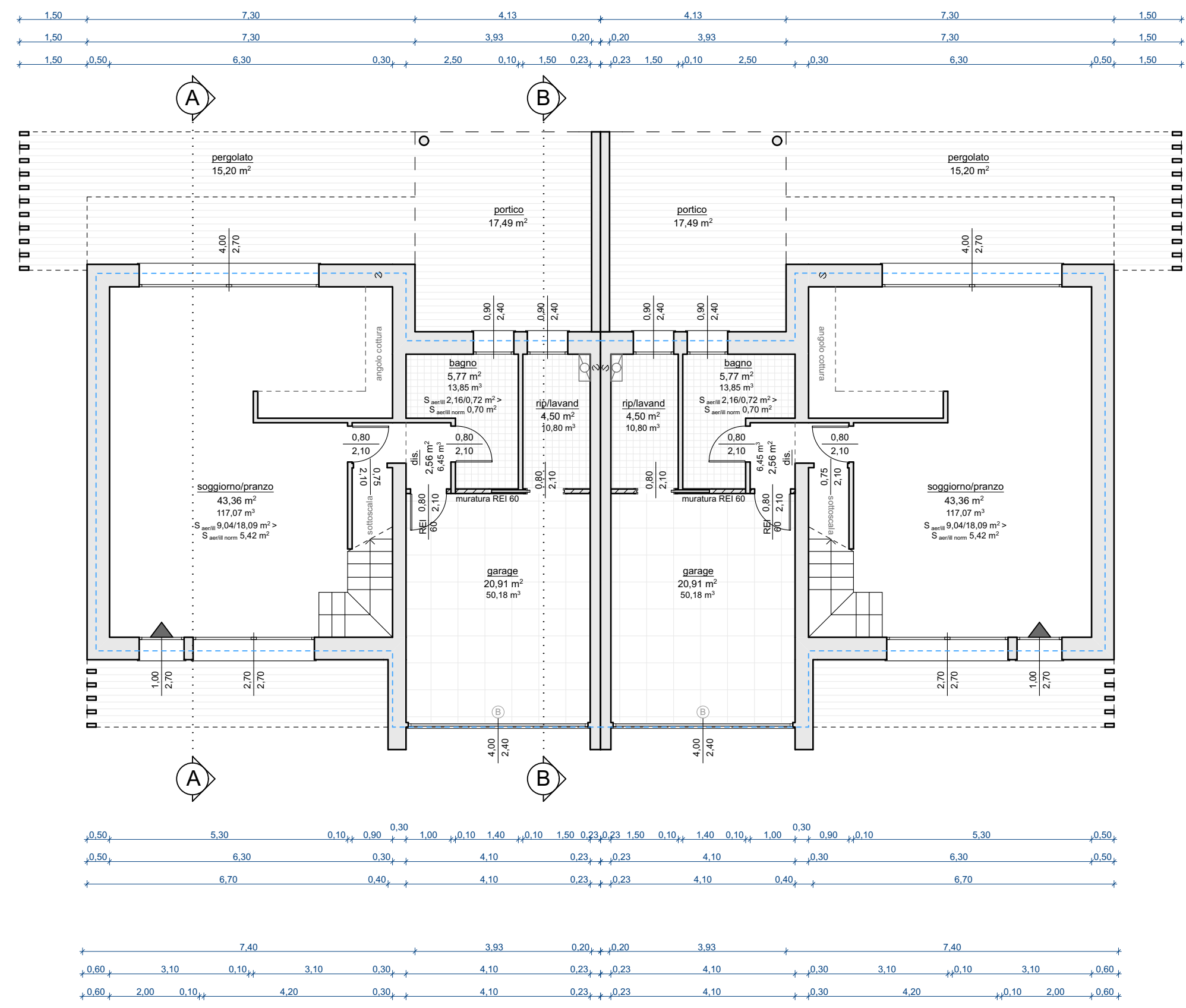
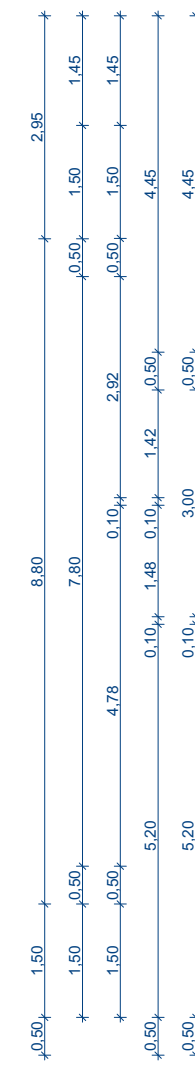

PIANTA PIANO PRIMO e SOTTOTETTO

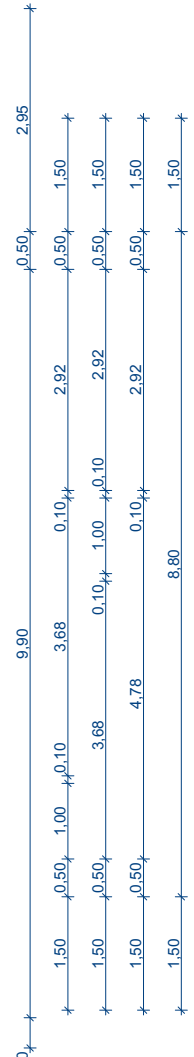
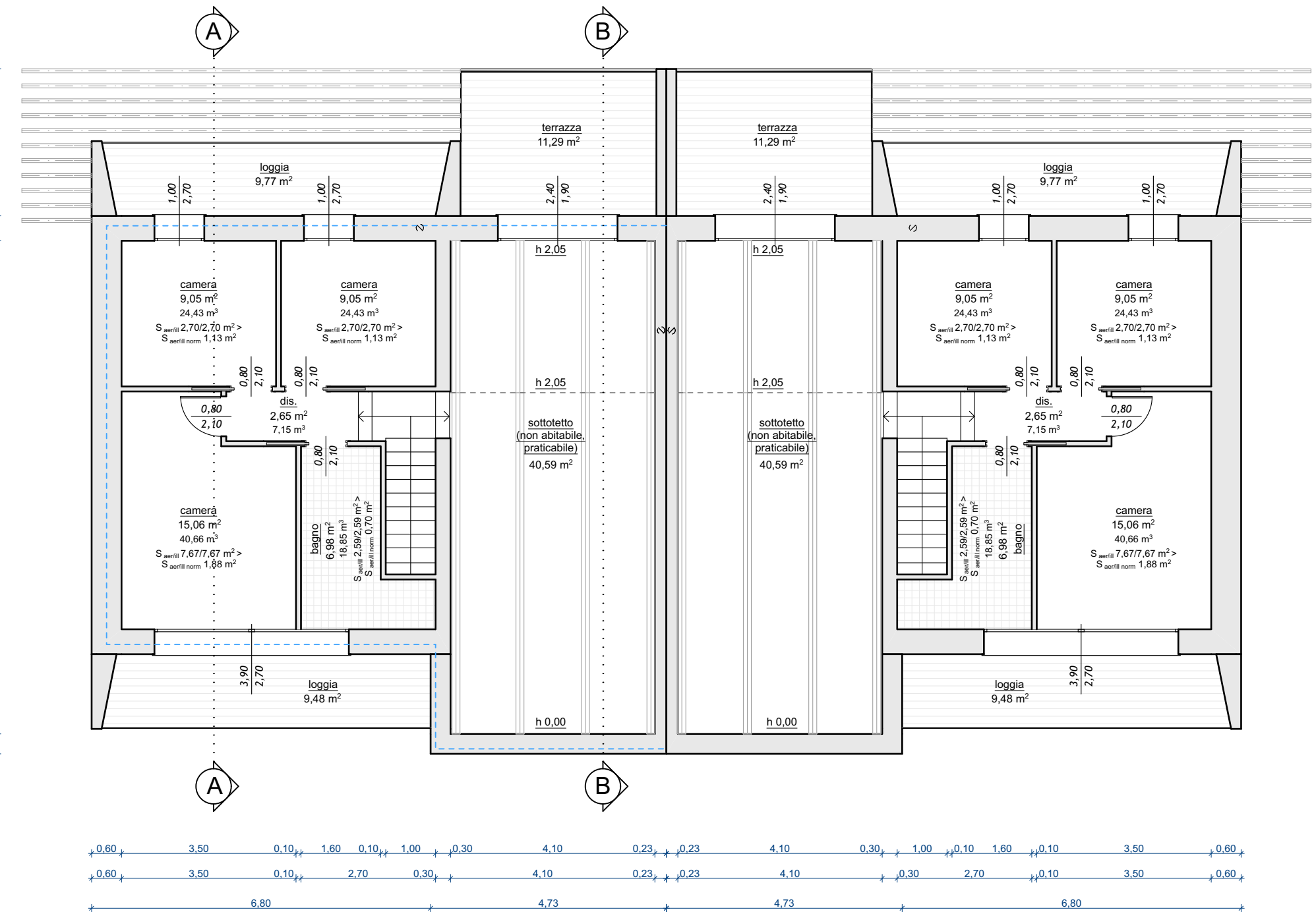
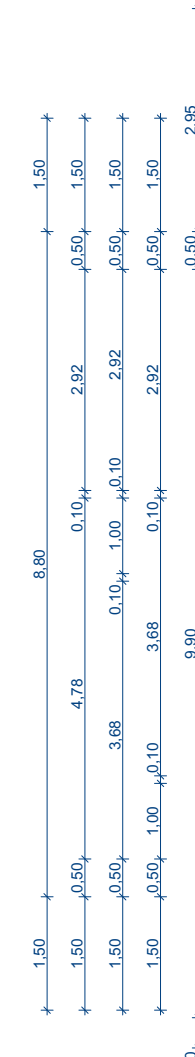

PIANTA COPERTURA

